



BRITISH

LEYLAND

**Land Rover Series IIA  
Parts Catalogue  
Bonneted Control Models**

Part No. 608024A

March 1974

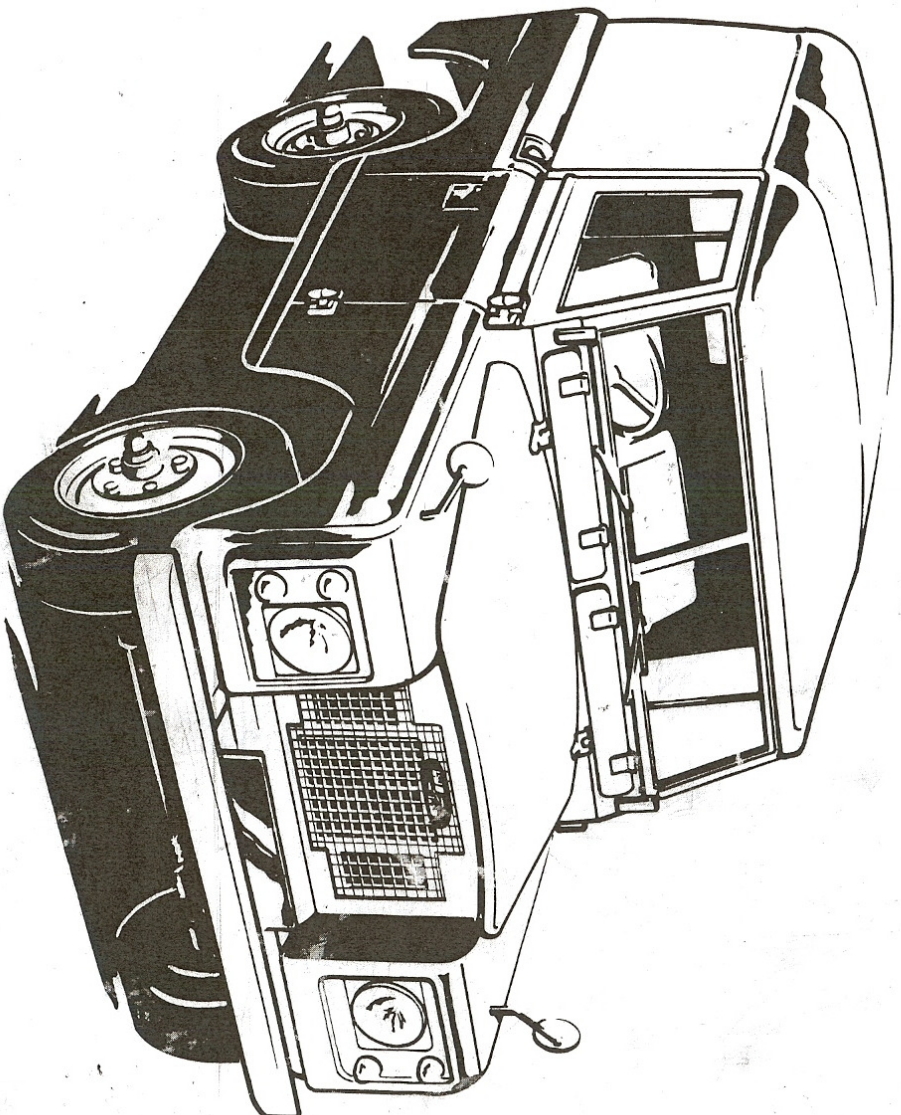

The following pages from 08 50 to 08 70 inclusive cover parts peculiar to Series 11A Land-Rover from Vehicle suffix 'H' onwards, all Synchromesh Gearbox fitted to Home Market 88 and 109 Station Wagons and Salisbury rear axle fitted to 109 models also miscellaneous parts required to accommodate these changes.

GEARBOX, MAIN CASING

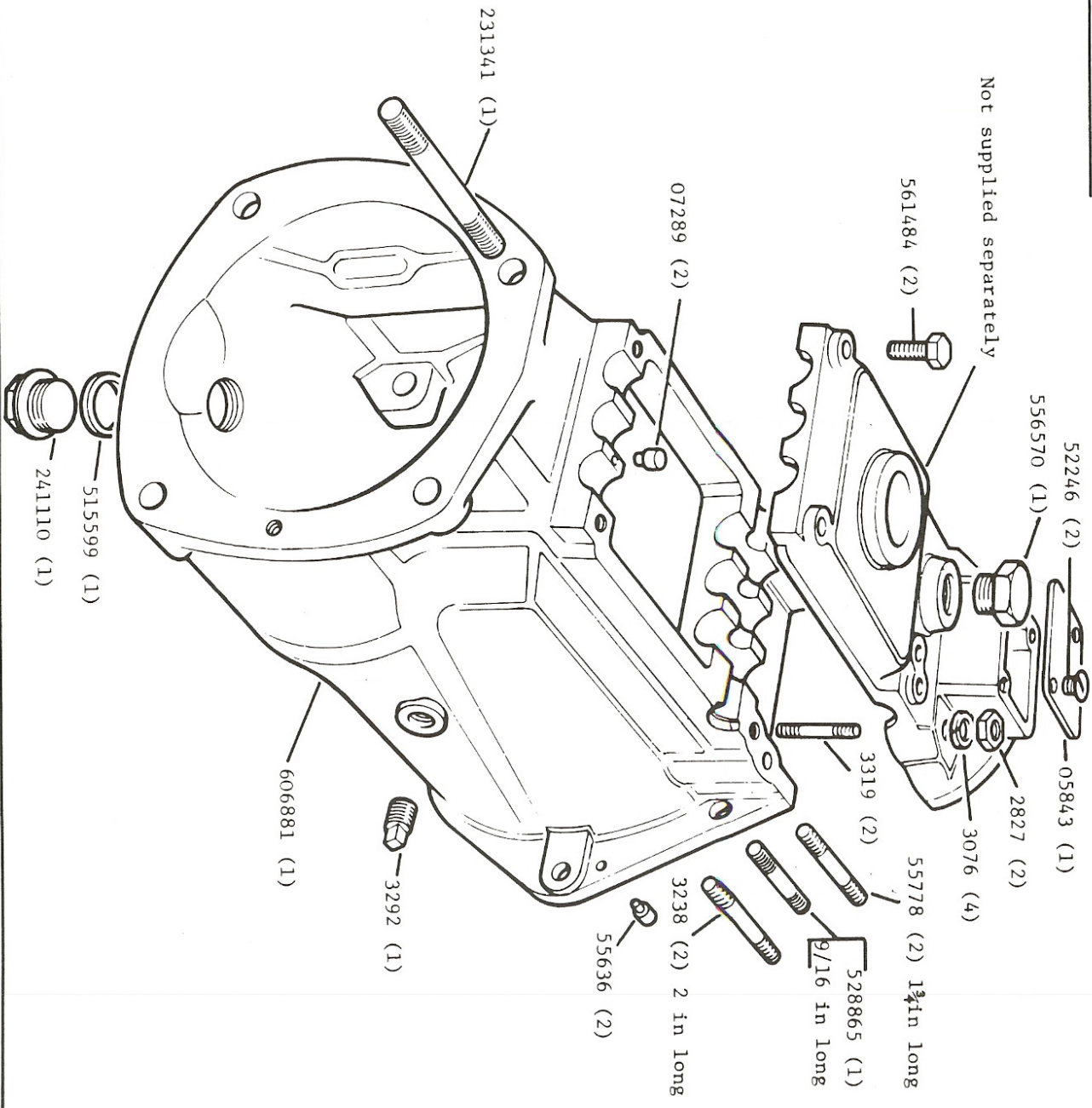

REMARKS

- Gearbox Assemblies
- 2 1/2 Litre Petrol & Diesel 576730 (1)
- 2.6 Litre Petrol 576761 (1)
- Gearbox gasket kit 600603 (1)

BELL HOUSING

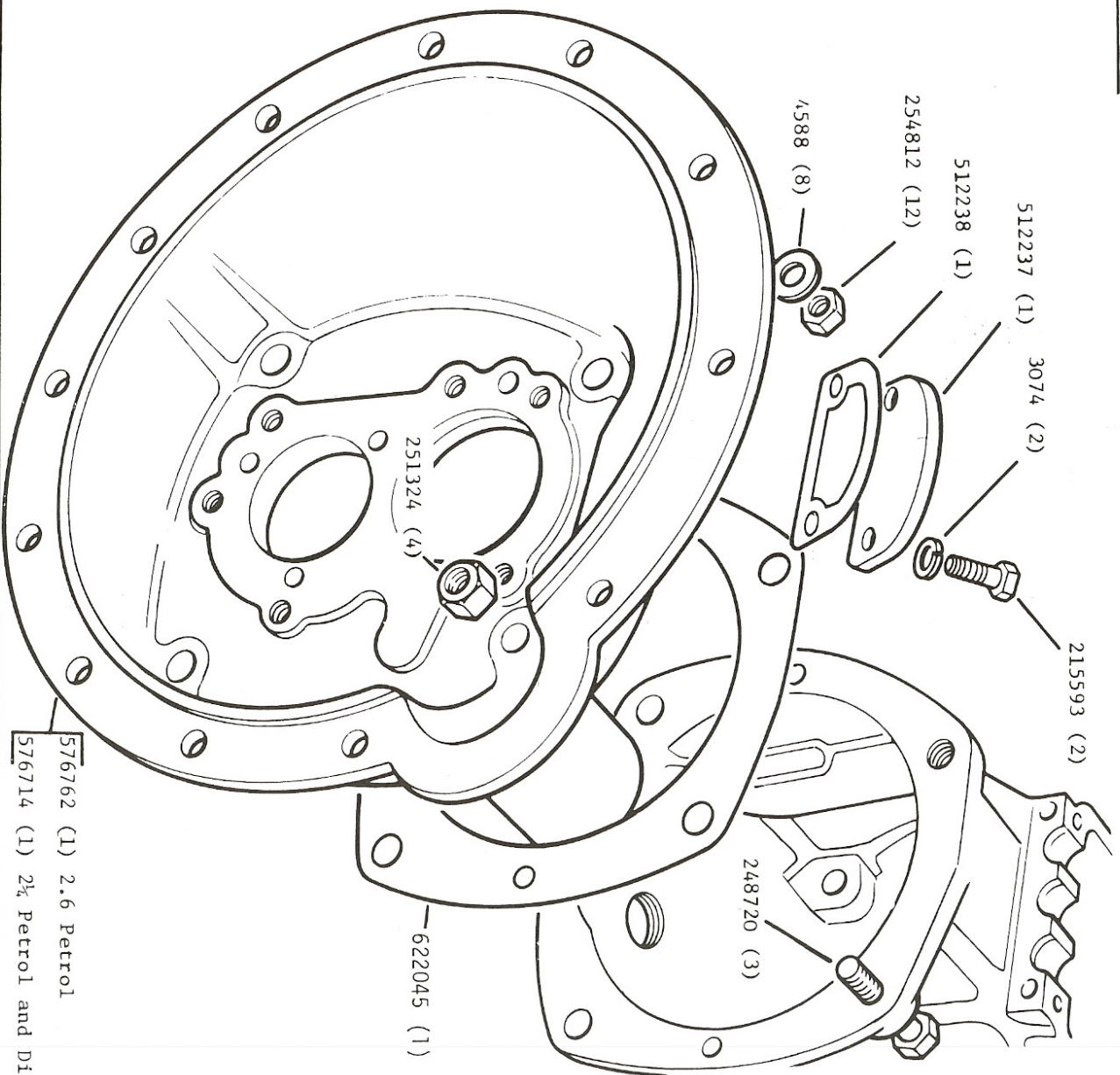

REMARKS

576762 (1) 2.6 Petrol  
576714 (1) 2½ Petrol and Diesel

FRONT COVER

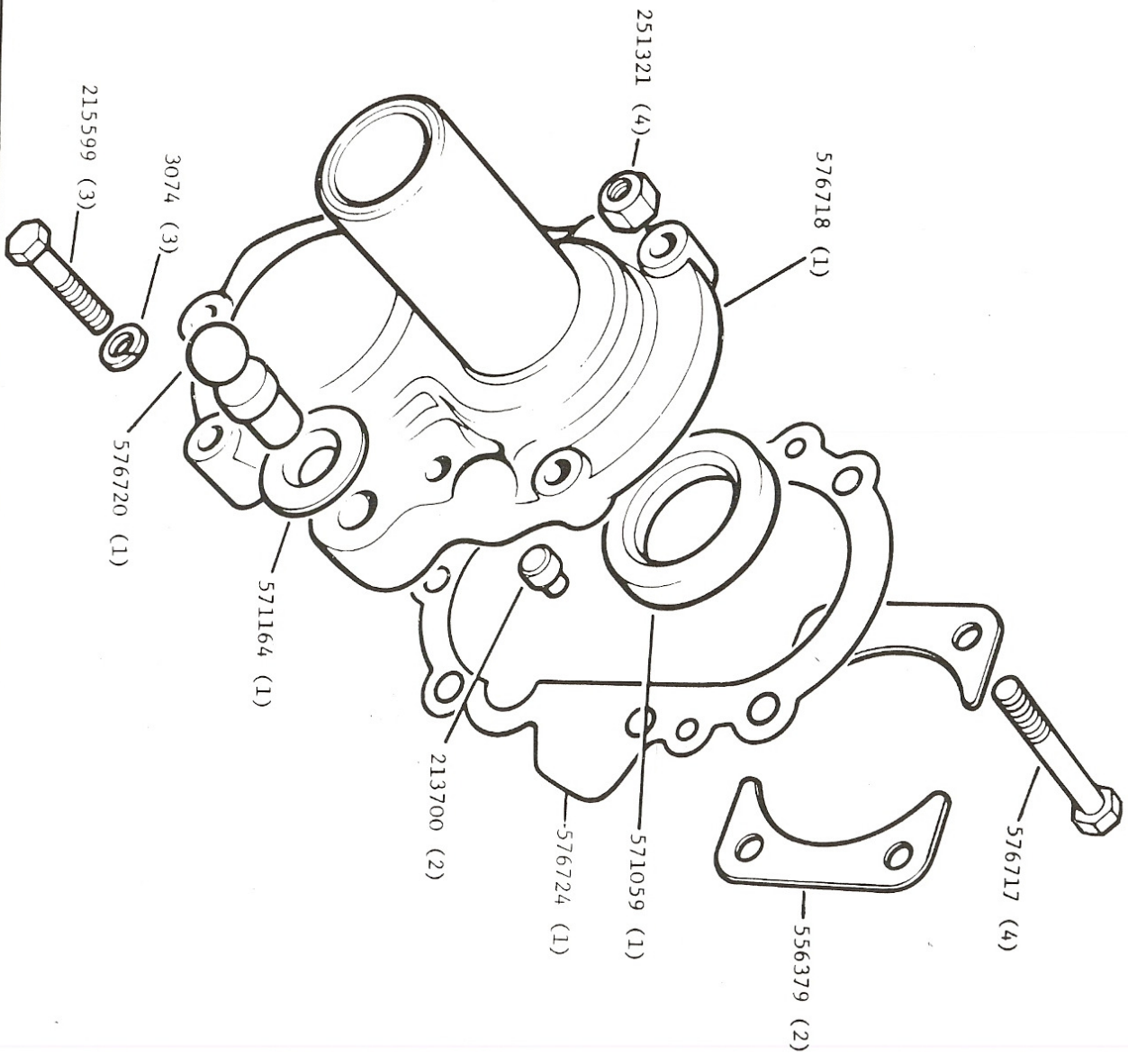

REMARKS

GEARBOX TRANSFER CASING

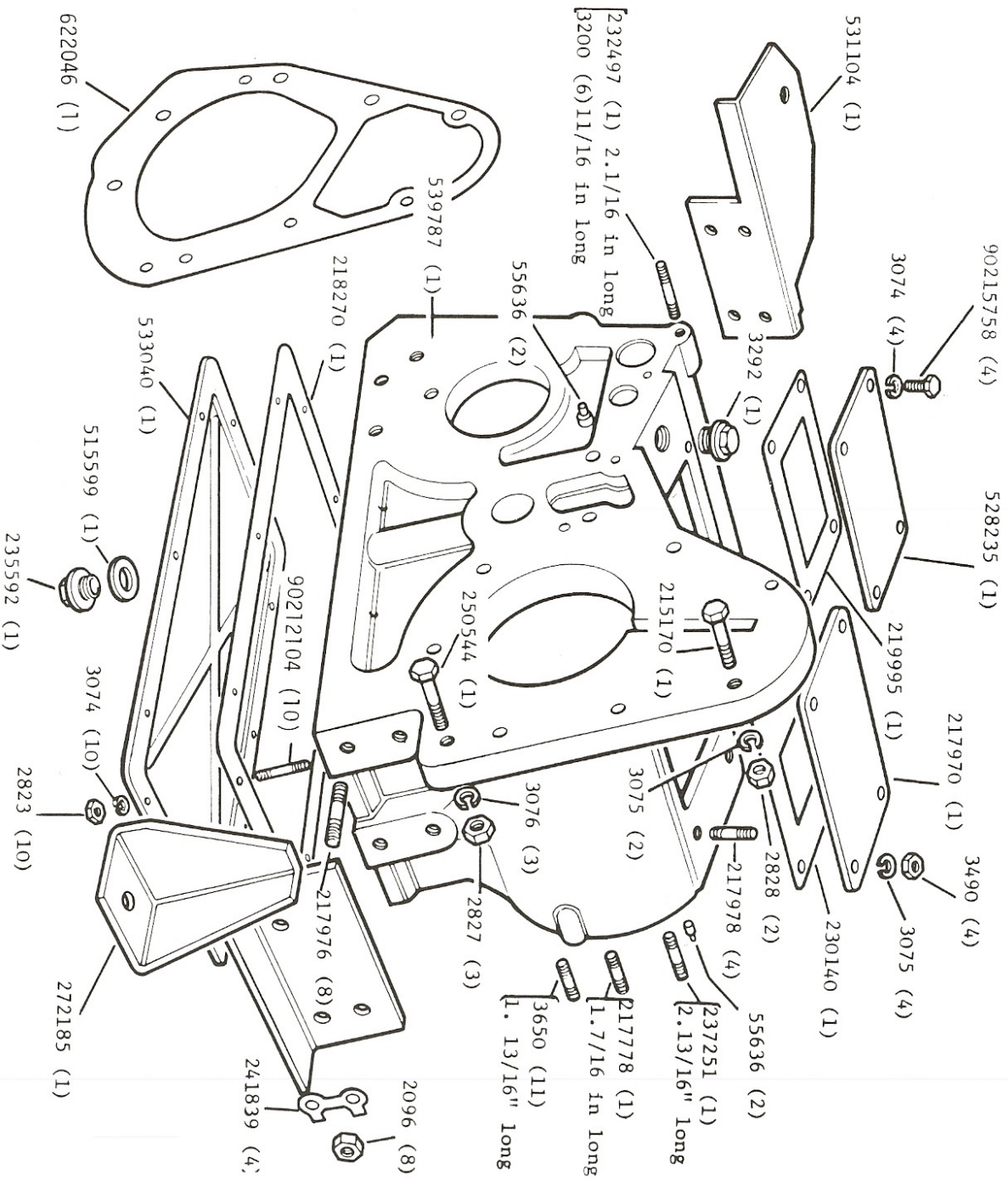

REMARKS

HOUSINGS, SPEEDOMETER PINION AND REAR MAINSHAFT BEARING

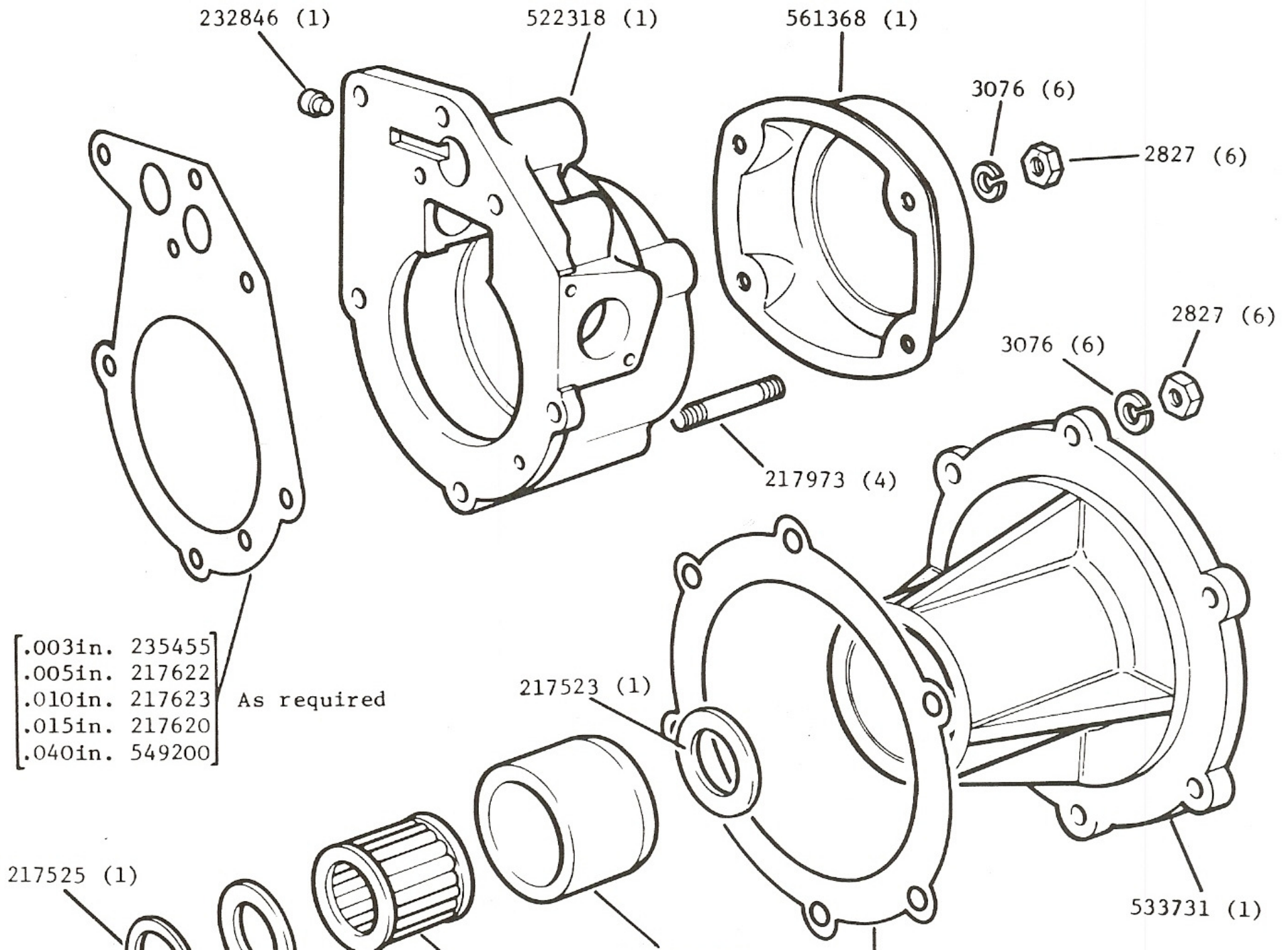

PRIMARY PINION AND MAINSHAFT, FRONT

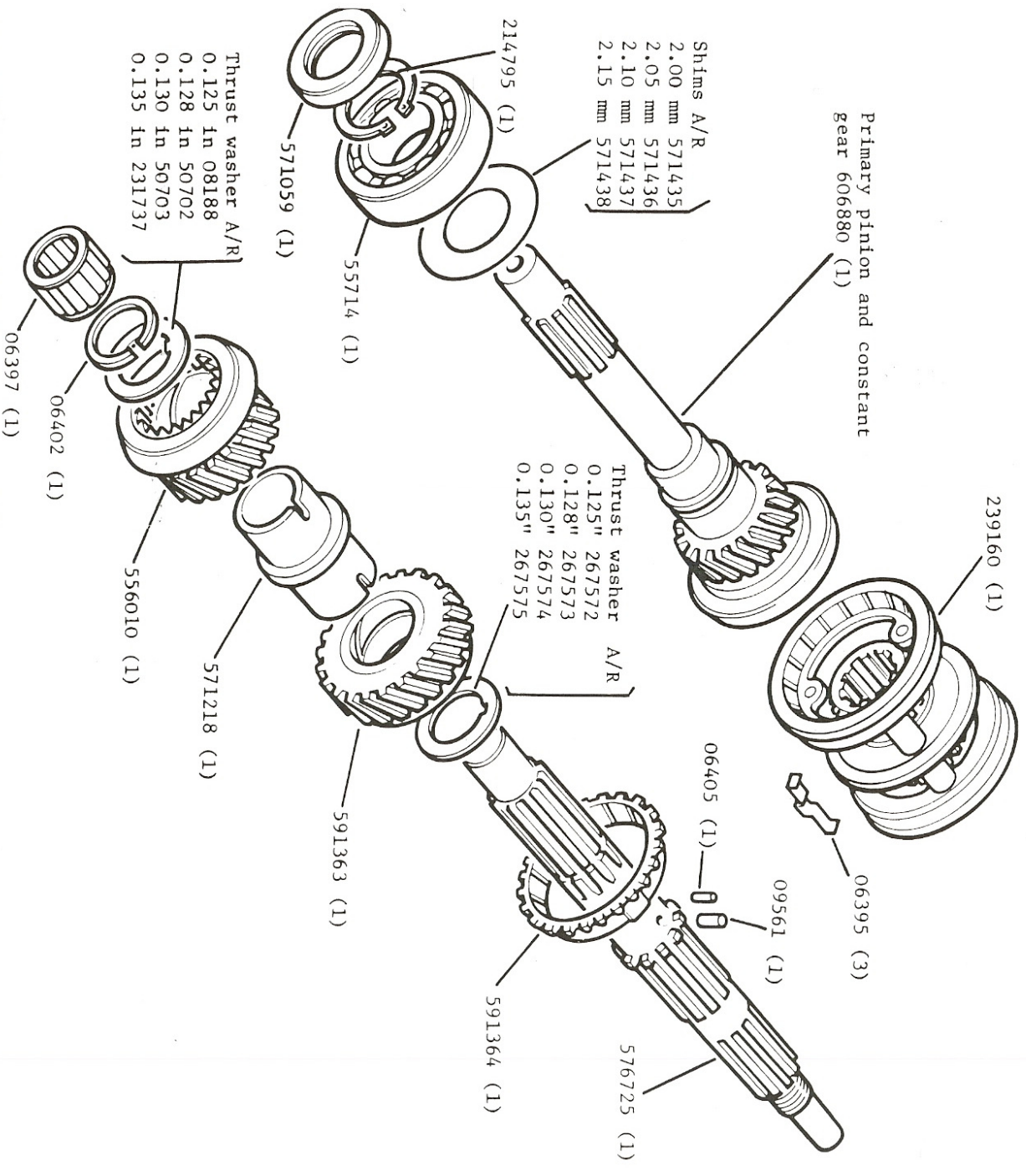

REMARKS

08 55

MAINSHAFT REAR

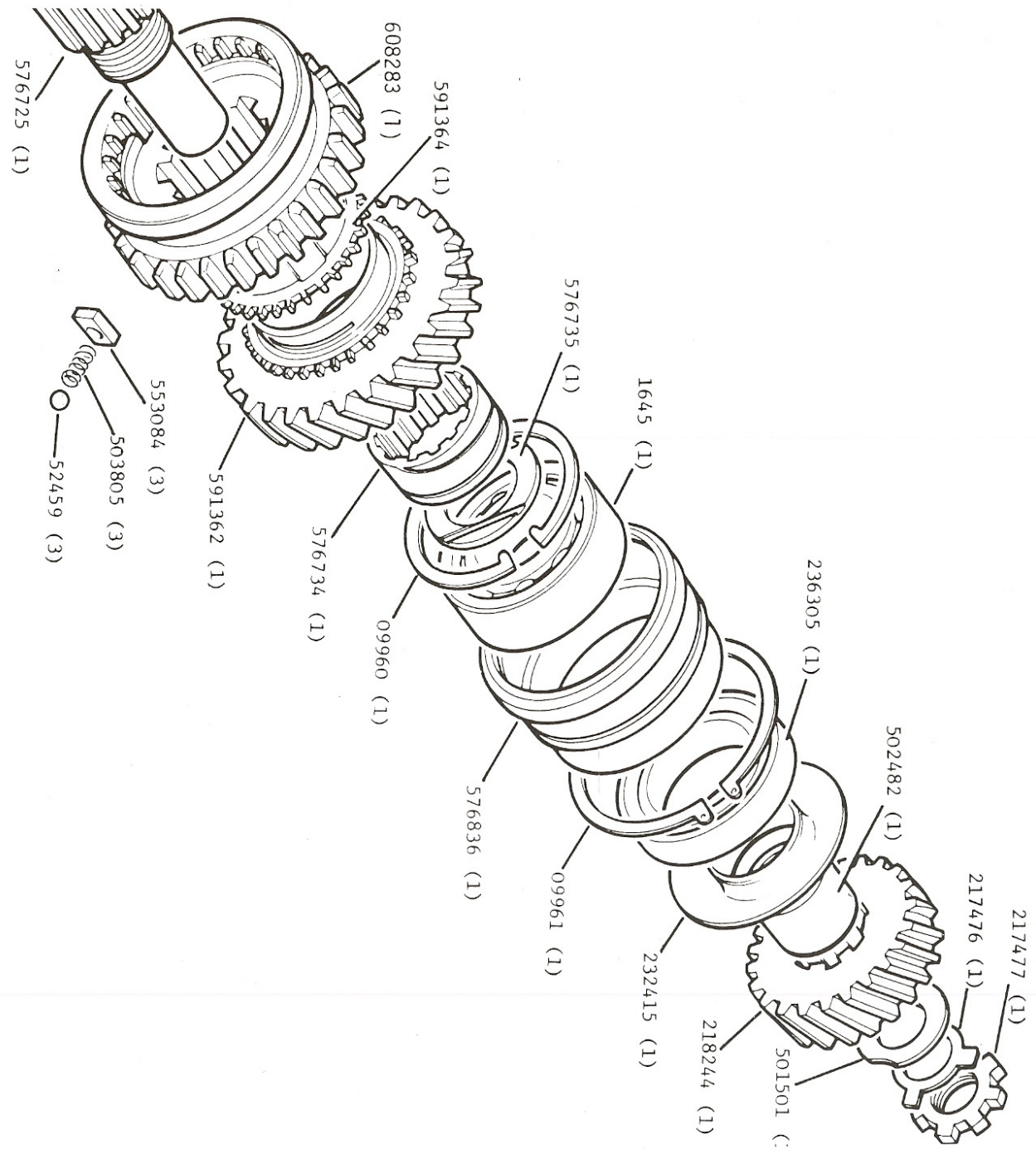

REMARKS

LAYSHAFT, GEARS AND REVERSE

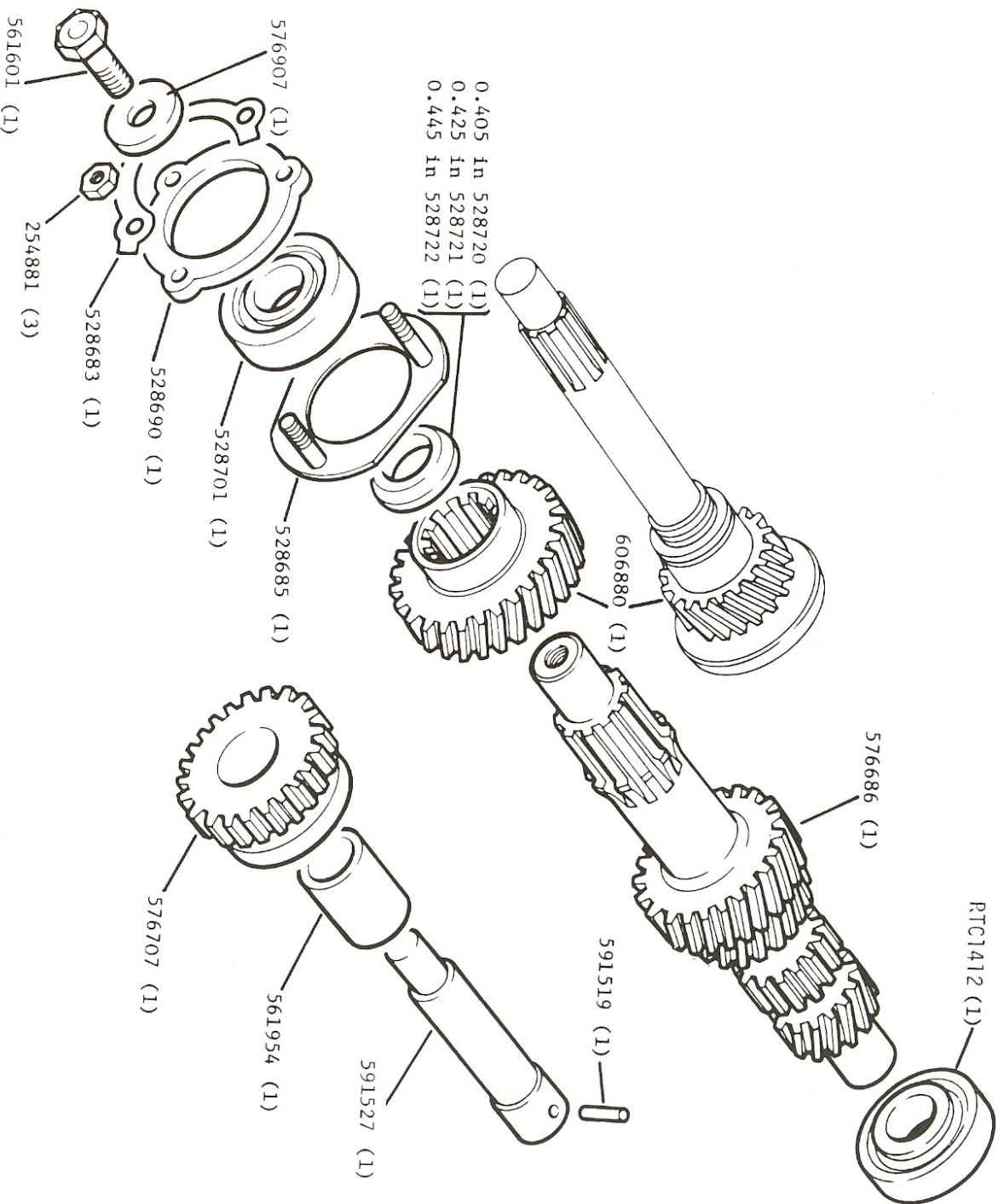

REMARKS

GEARBOX, INTERMEDIATE AND HIGH GEAR WHEEL

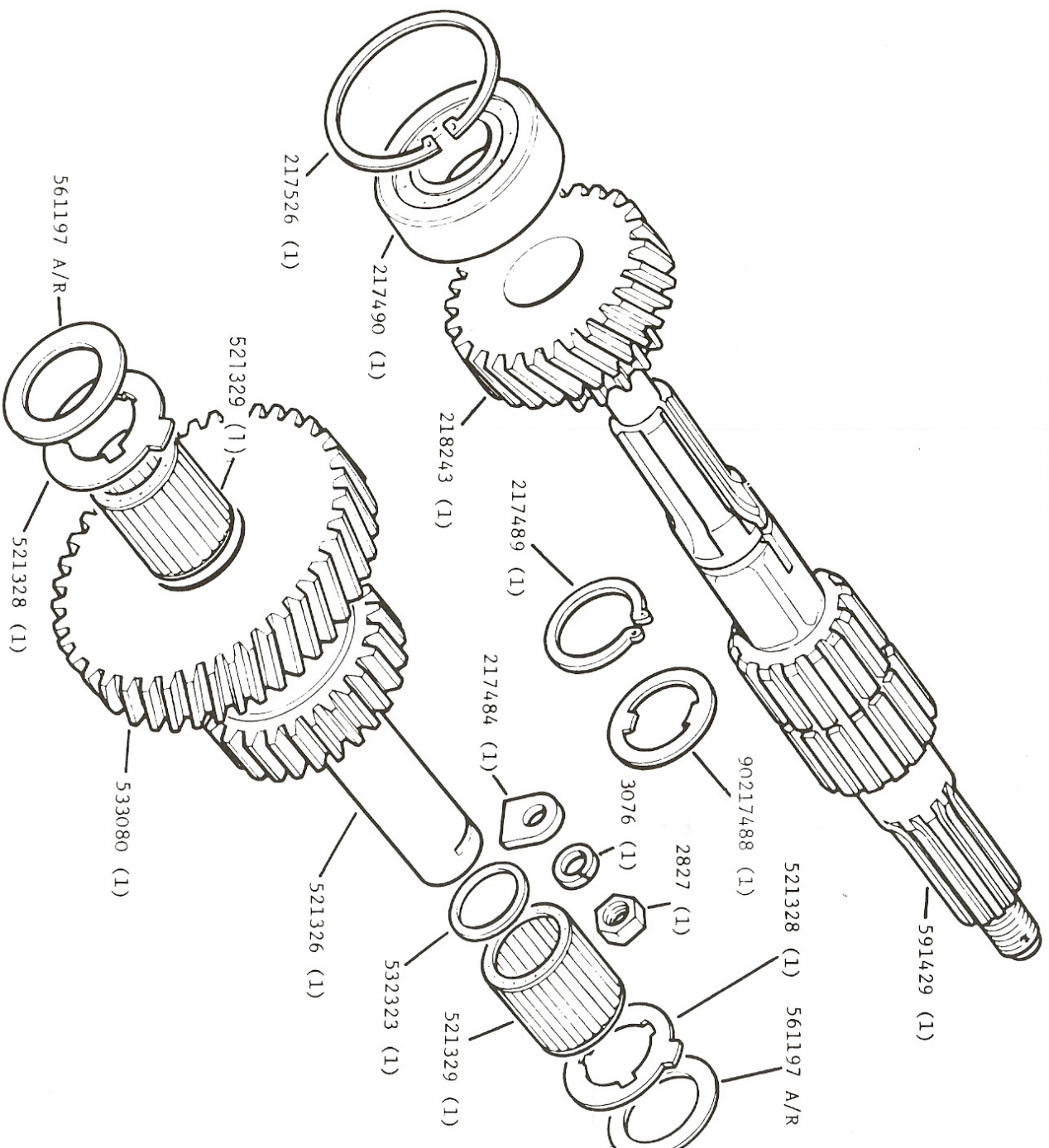

REMARKS

GEARBOX, LOW GEAR WHEEL AND SPEEDOMETER DRIVE

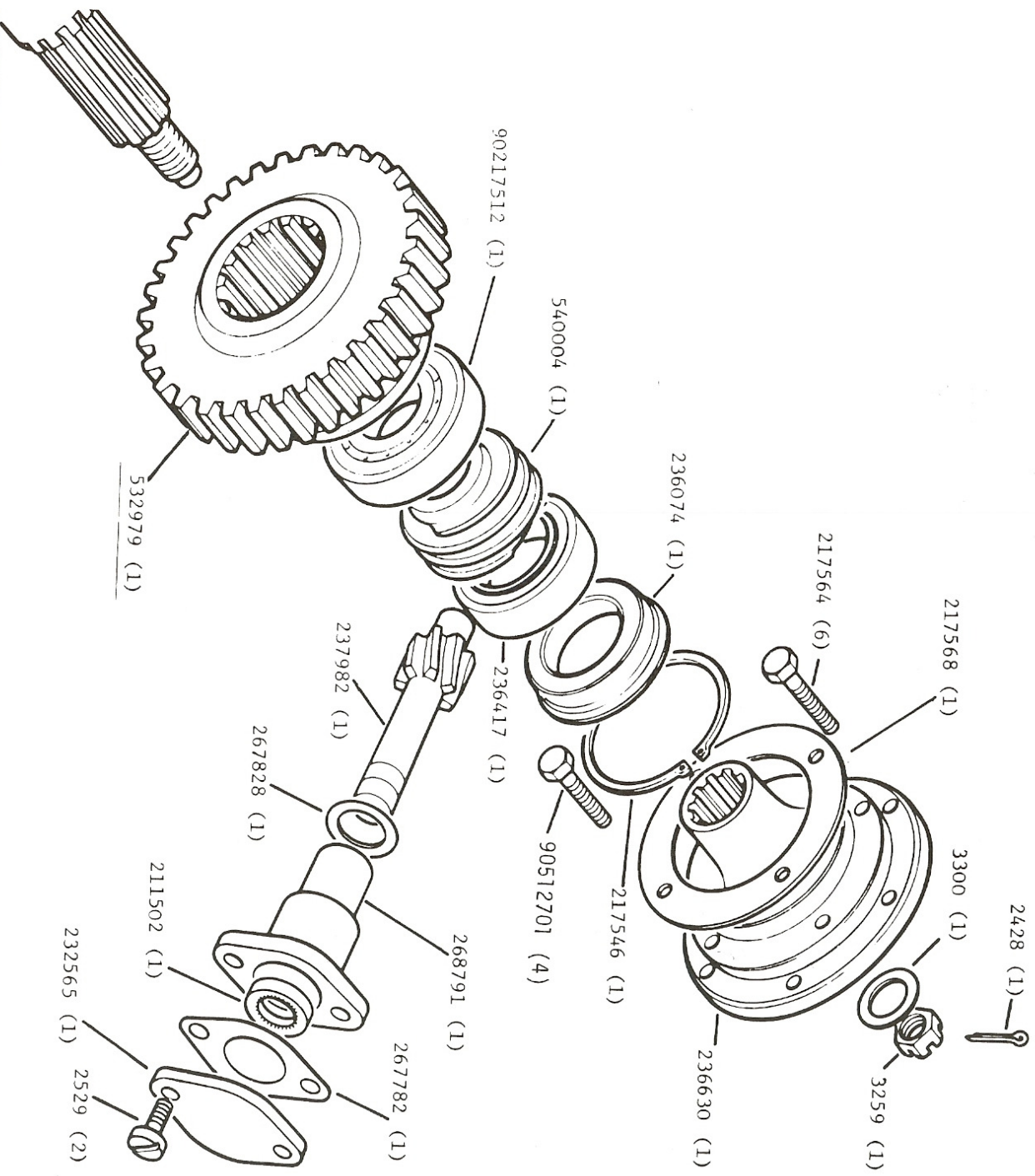

REMARKS

GEARBOX, SELECTORS AND LEVERS

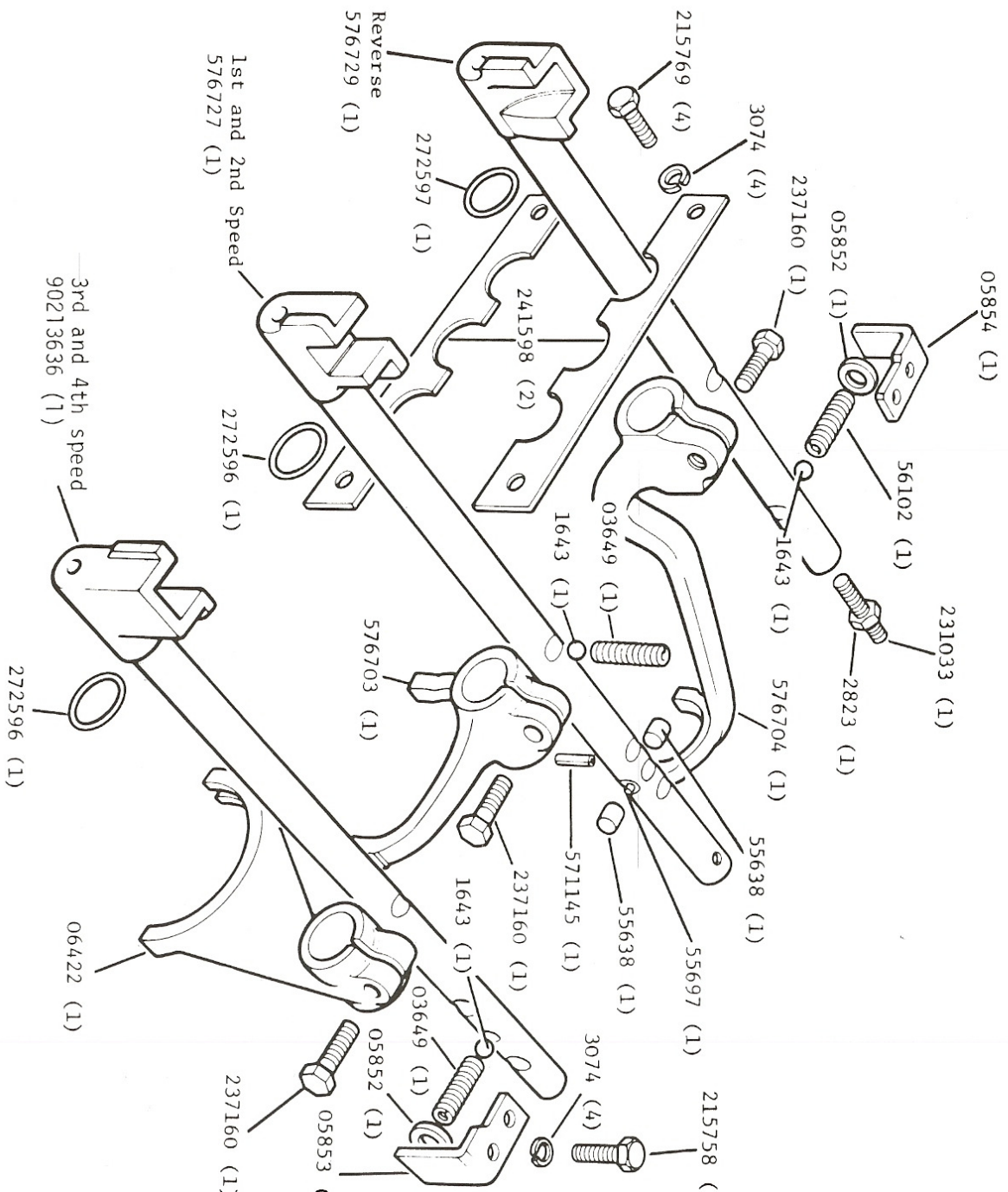

REMARKS

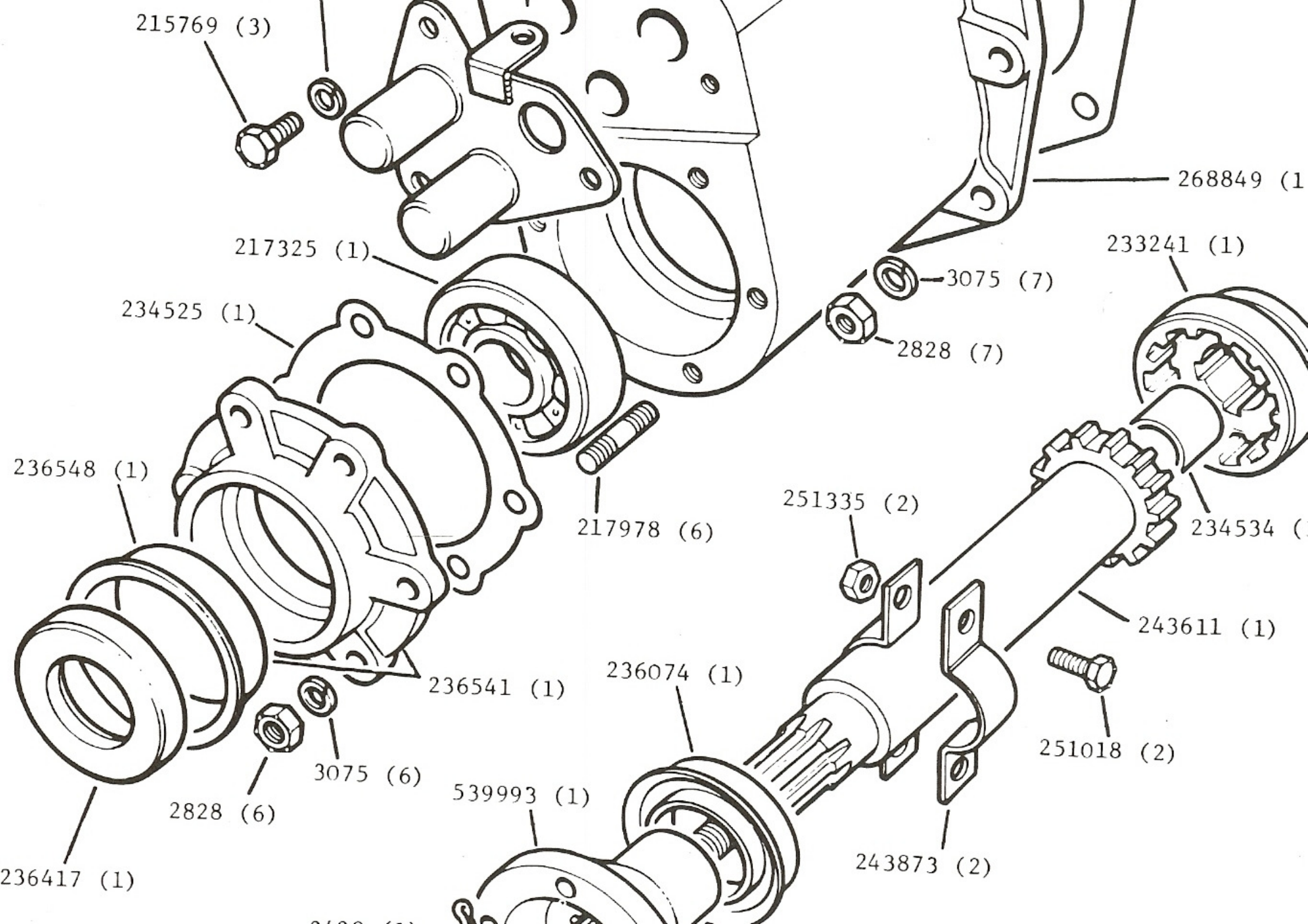

MAIN GEAR LEVER

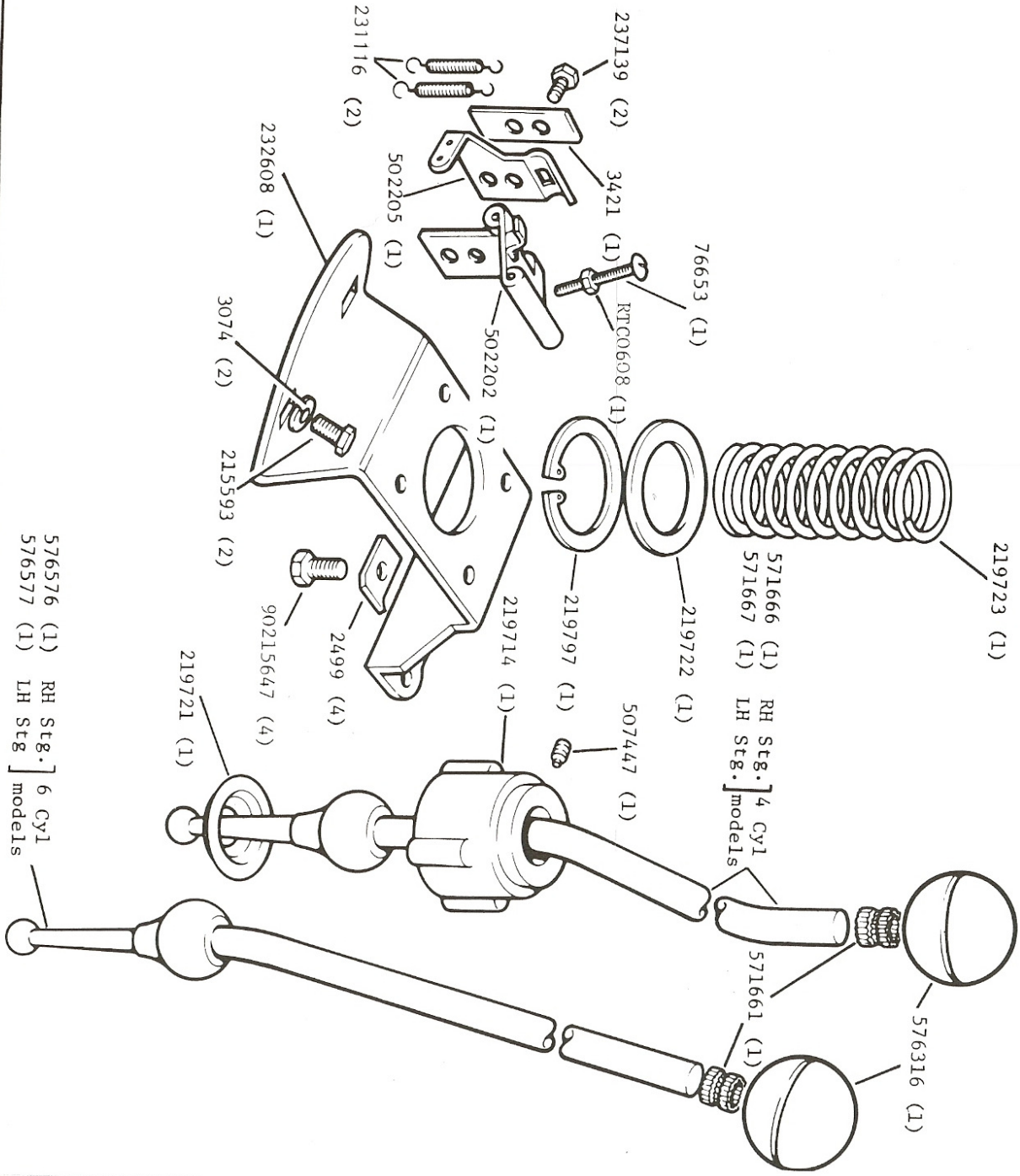

REMARKS

Gear change lever assy's :-

576311 (1) RH Stg. 4 Cy1  
 576312 (1) LH Stg. models

576578 (1) RH Stg 6 Cy1  
 576579 (1) LH Stg models

576576 (1) RH Stg. ] 6 Cy1  
 576577 (1) LH Stg. ] models

SELECTOR SHAFT, FOUR WHEEL DRIVE

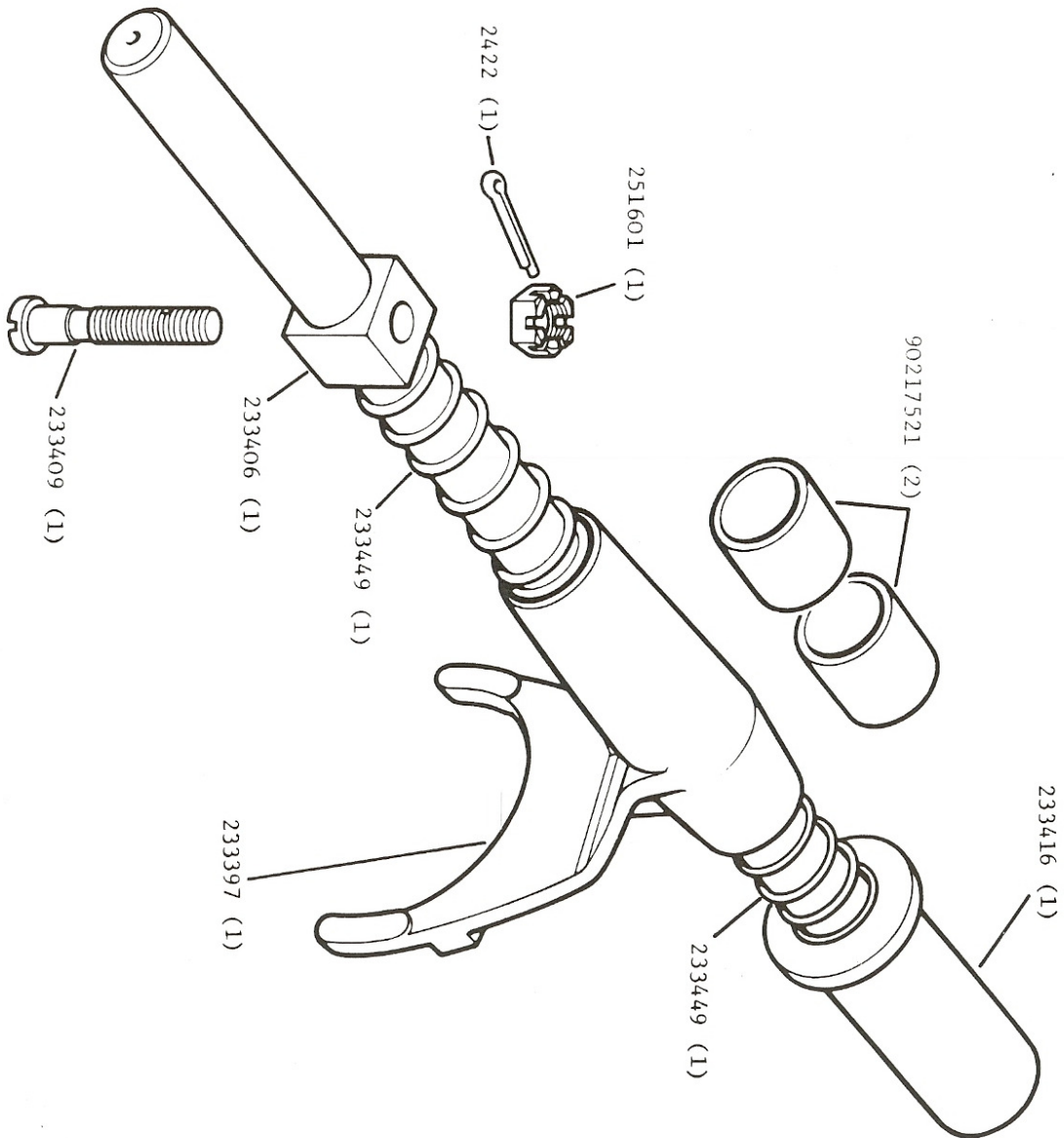

REMARKS

SELECTOR FORK, TRANSFER GEAR LEVER

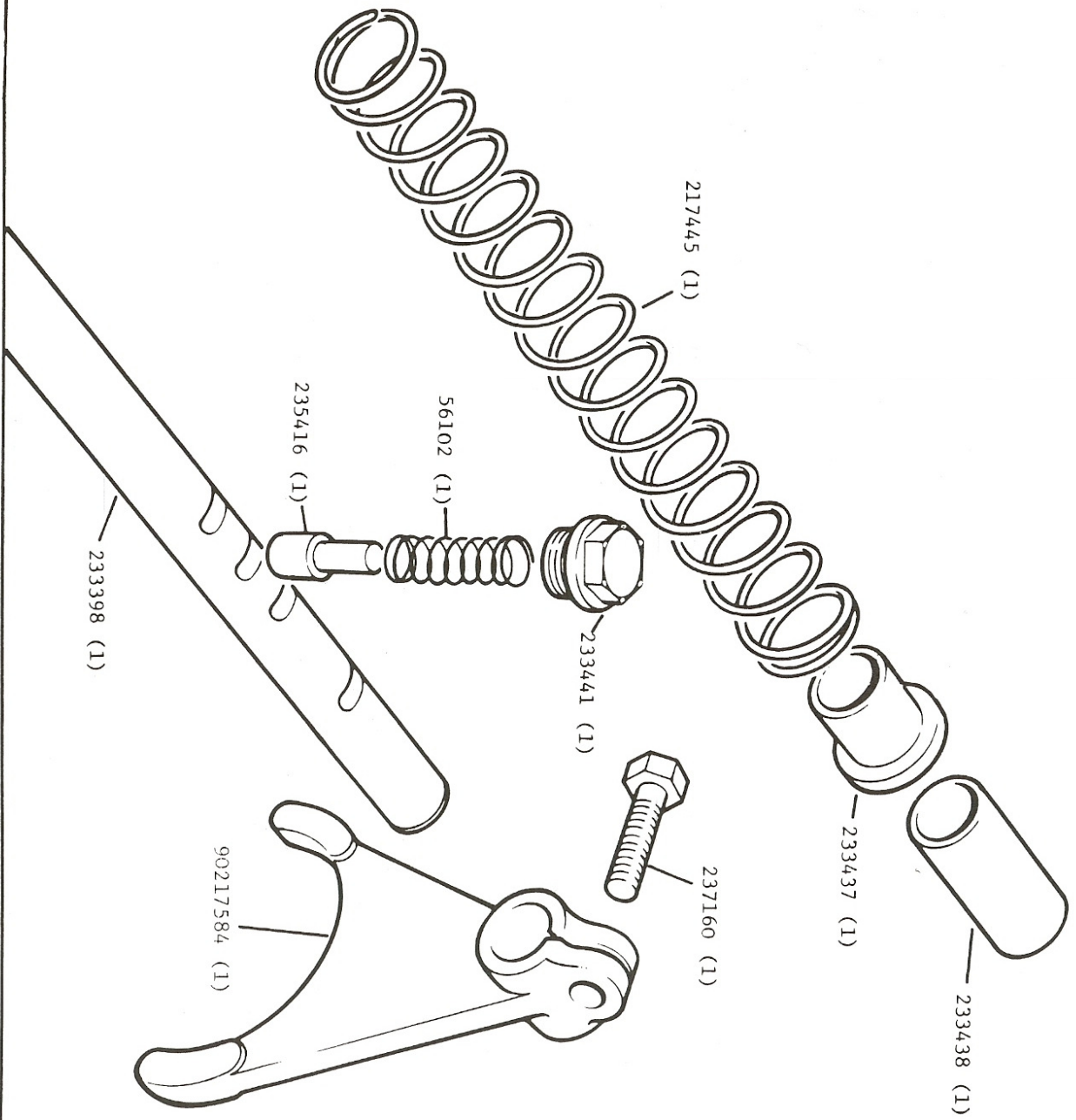

REMARKS

SELECTOR ROD, FOUR WHEEL DRIVE

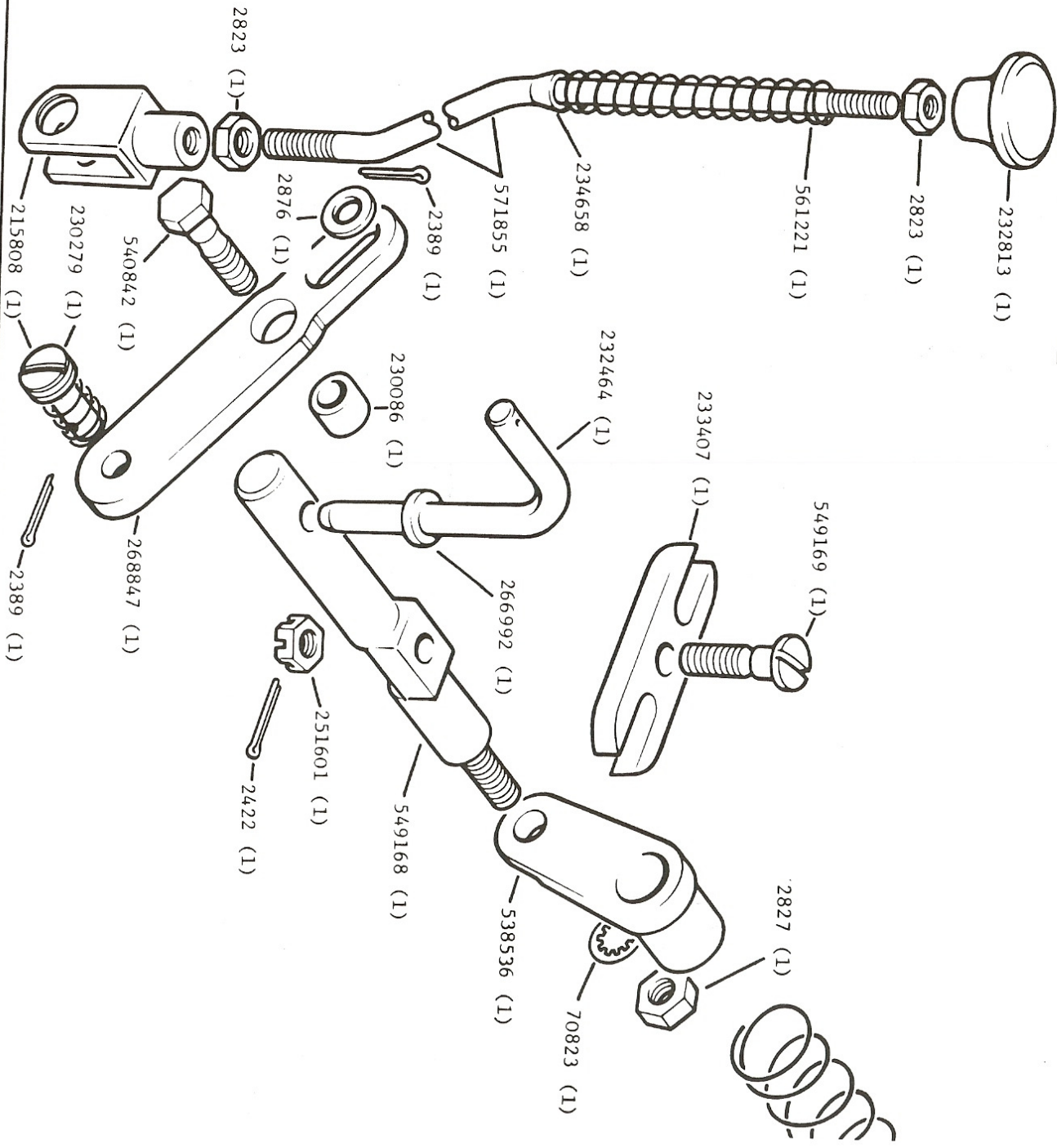

REMARKS

TRANSFER GEAR CHANGE LEVER

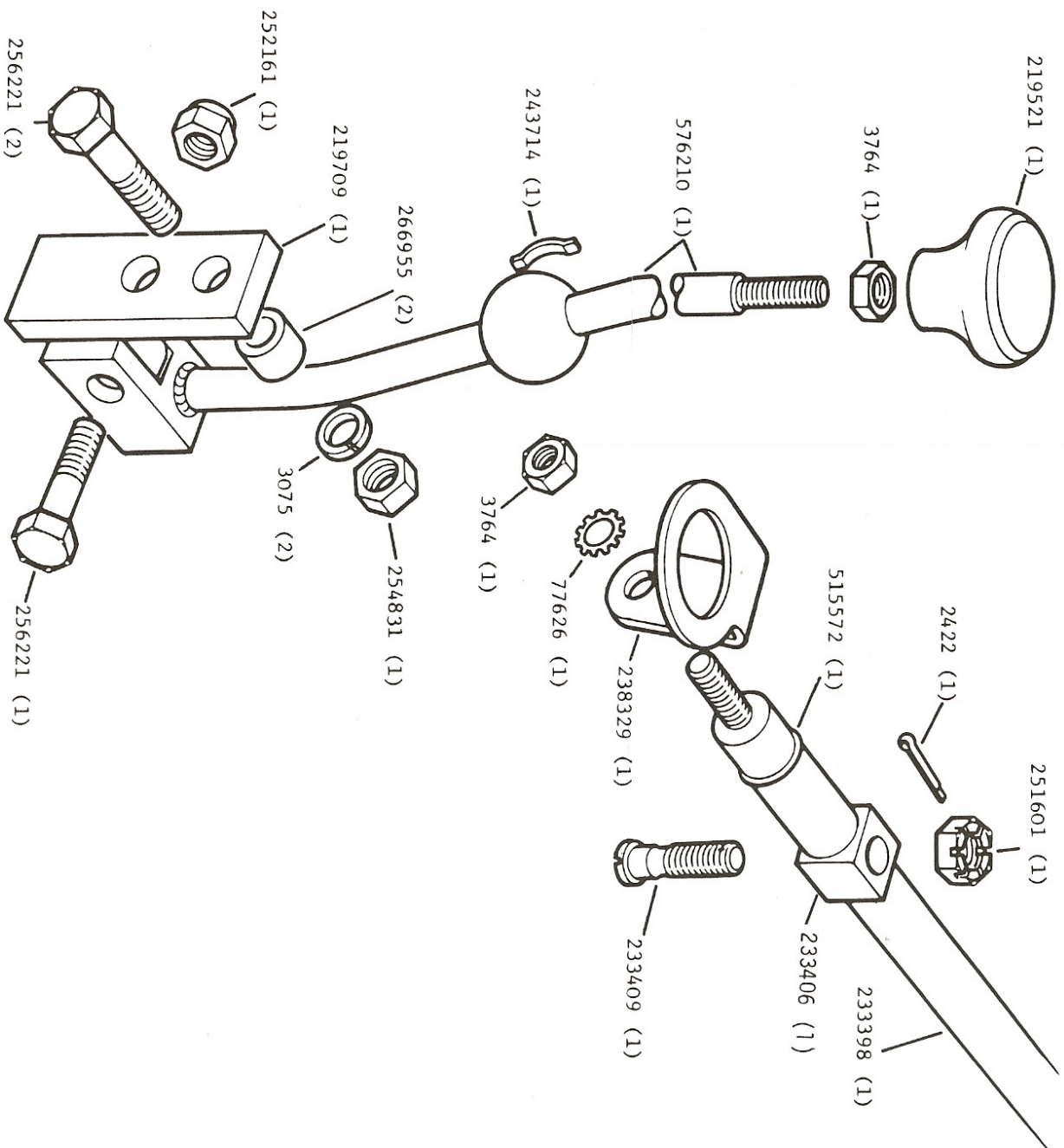

REMARKS

AXLE CASING - 109" REAR AXLE

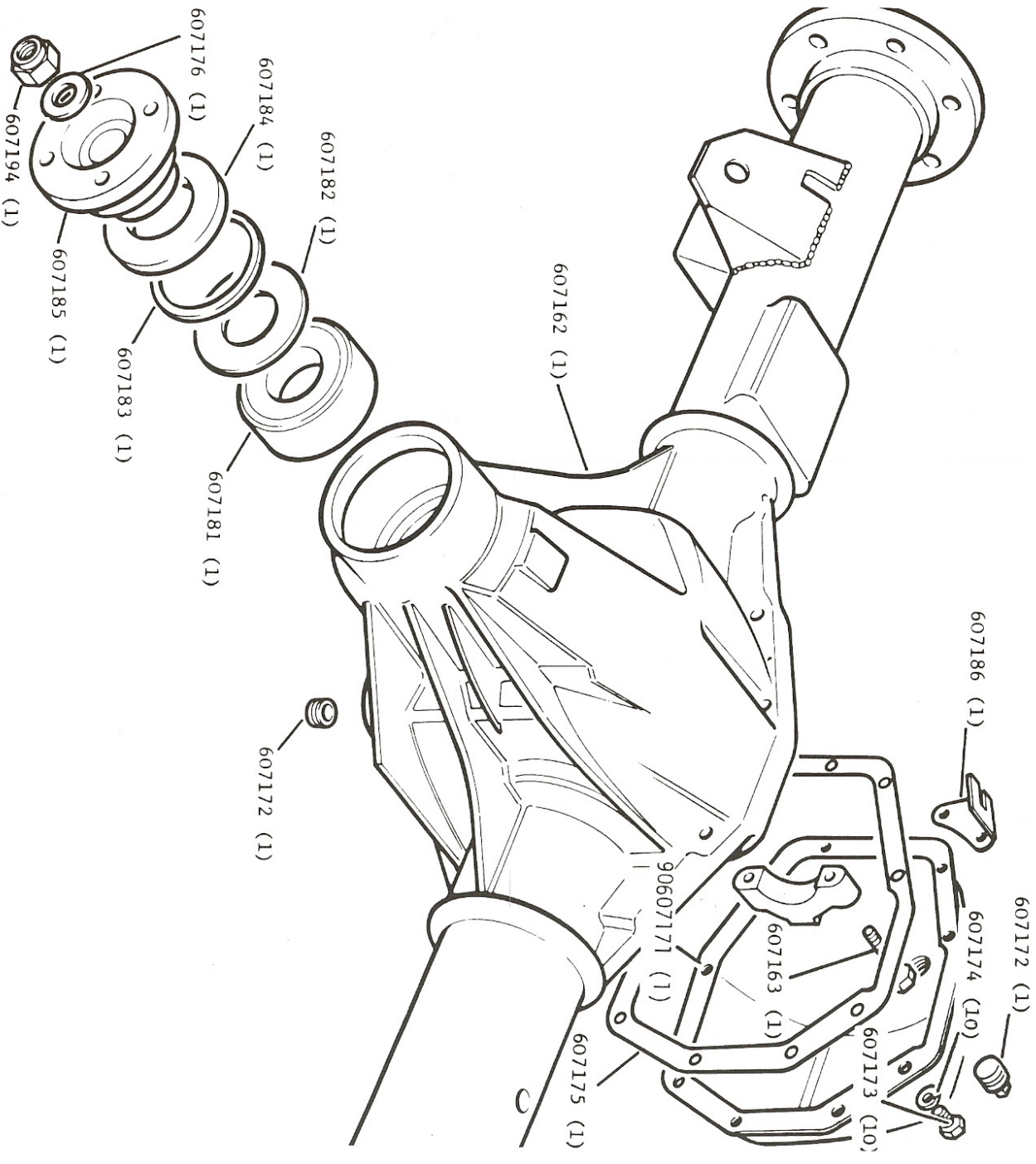

REMARKS

Rear axle assembly 576764 (1)  
Rear axle assembly less hubs brake units and axle shafts 607247 (1)

DIFFERENTIAL 109" REAR AXLE

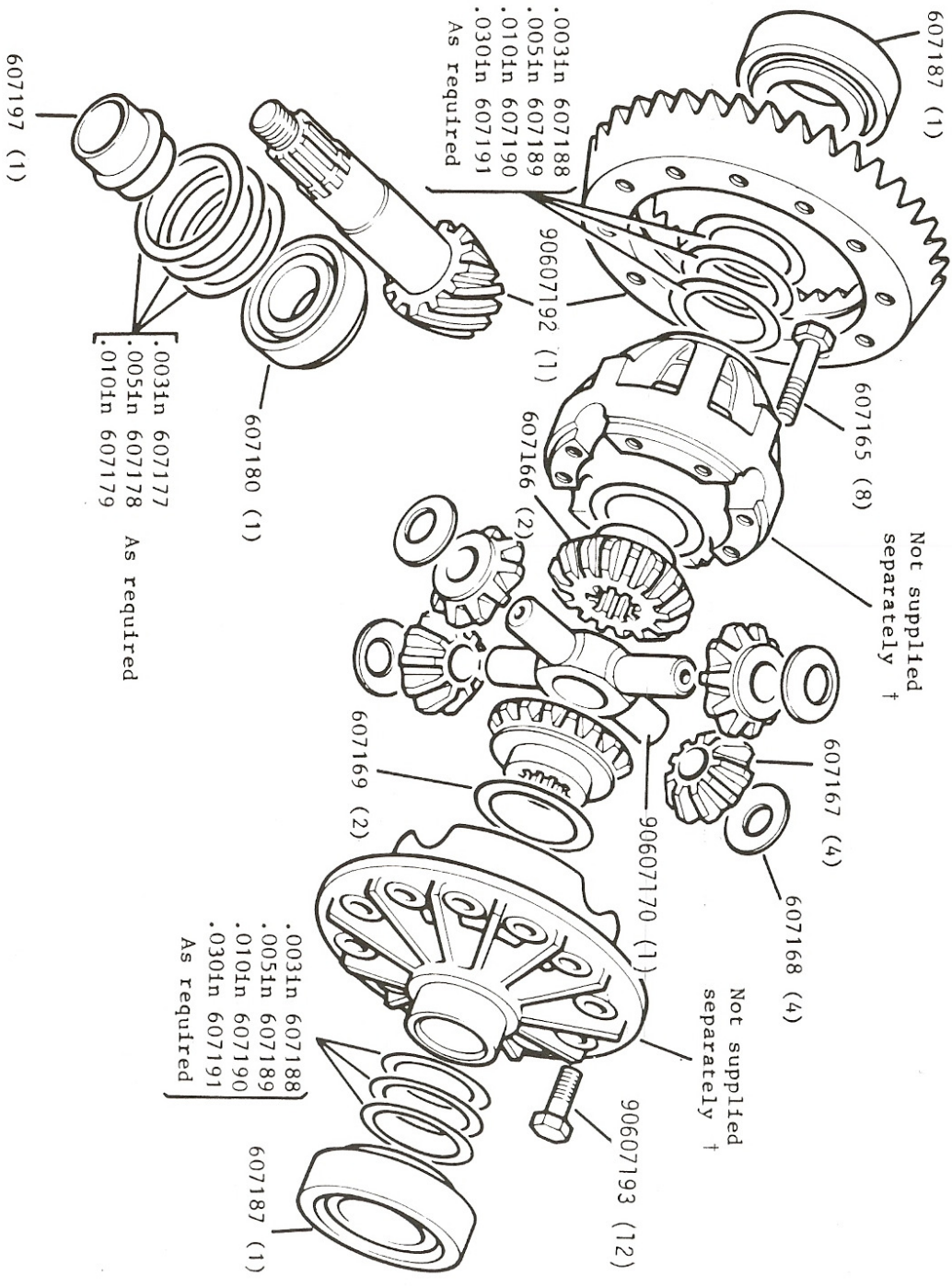

REMARKS

† Differential case less gears 607164 (1)

HUB AND AXLE SHAFT 109 REAR AXLE

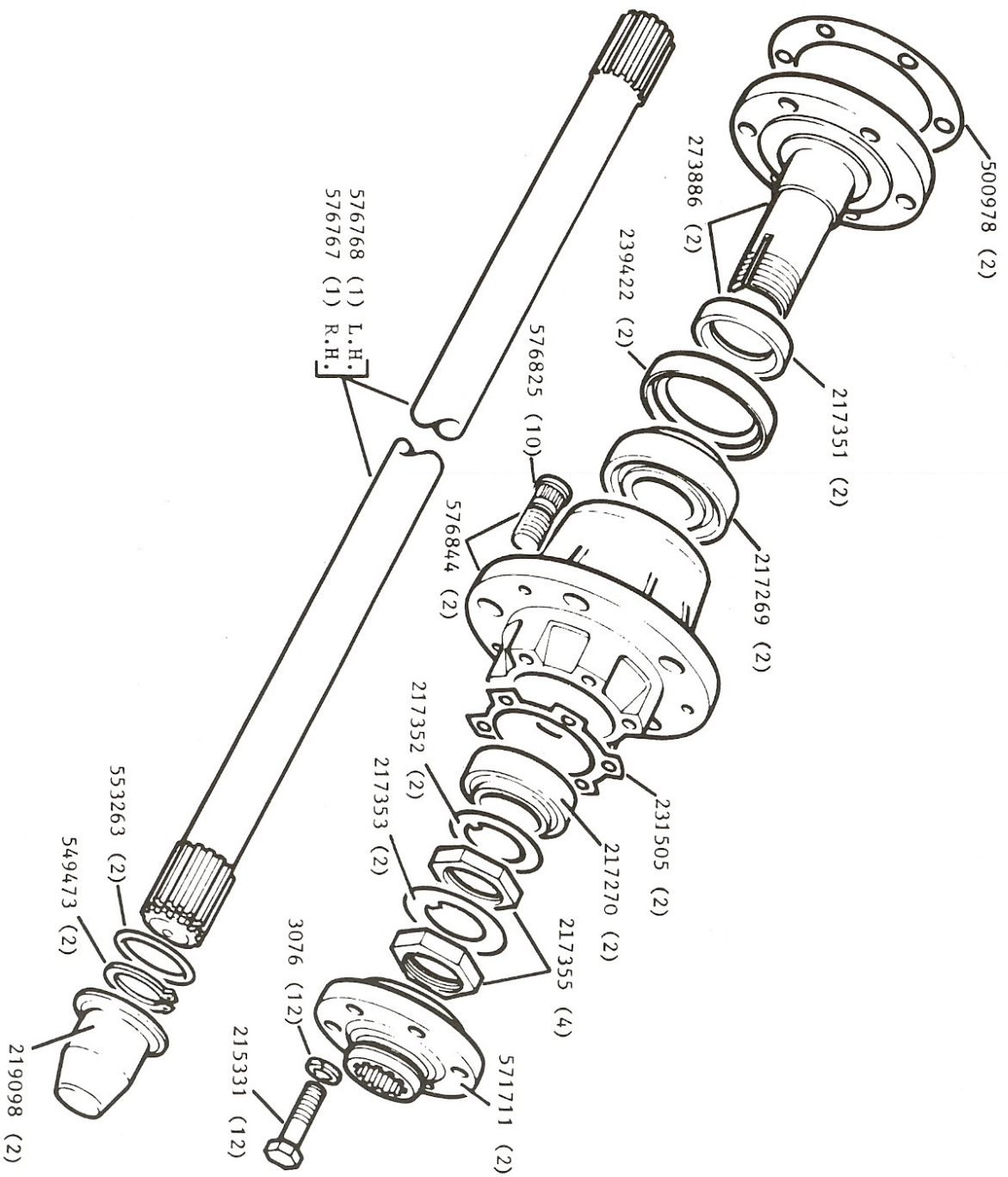

REMARKS

Plate	1	2	3	4	Description	Qty.	Part No.	Remarks
					Miscellaneous changes to accommodate the all synchromesh Gearbox fitted to Home Market Series IIA 88 and 109 Station Wagons and the Salisbury rear axle fitted to Series IIA 109 models.			
					The above changes were incorporated from vehicle suffix 'H' onwards.			
Chassis frame						1	598592	88
Chassis frame						1	599423	109 4-cylinder except Station Wagon
Chassis frame						1	594683	109 4-cylinder Station Wagon
Chassis frame						1	594697	109 6-cylinder except Station Wagon
Chassis frame						1	594698	109 6-cylinder Station Wagon
Check strap for rear axle						2	592181	
Brake pipe on axle RH						1	577670	
Brake pipe on axle LH						1	577671	
Rear spring bottom plate						2	592179	
'U' bolt for rear spring						4	592182	
Self-locking nut (12 mm) for 'U' bolt						8	810502	
Brake drum, rear						2	576973	
Clutch assembly						1	576557	
Clutch plate						1	571712	4-cylinder petrol
Support plate for clutch jump hose						1	587621	4-cylinder
Support plate for clutch jump hose						1	587622	6-cylinder
Clutch slave cylinder						1	591231	
Push rod for clutch slave cylinder						1	576751	
Clip fixing push rod to release lever						1	576723	
Pipe, clutch master cylinder to jump hose bracket						1	592508	4-cylinder. RH Stg
Pipe, clutch master cylinder to jump hose bracket						1	592509	6-cylinder. RH Stg
Pipe, clutch master cylinder to jump hose bracket						1	569702	6-cylinder. LH Stg
Clutch jump hose						1	592515	4-cylinder
Clutch jump hose						1	592511	6-cylinder
Pipe, jump hose bracket to clutch slave cylinder						1	592383	4-cylinder
Pipe, jump hose bracket to clutch slave cylinder						1	592384	6-cylinder
Adaptor for clutch master cylinder						1	90512650	
Mounting bracket for clutch jump hose						1	569462	6-cylinder. RH Stg only
Bleed pipe for clutch slave cylinder						1	594776	
Adaptor for bleed pipe						1	594822	
Bracket, clutch slave cylinder bleed pipe						1	593664	
Bolt (5/16" UNF x 1 $\frac{3}{8}$ " long)						2	256023	
Spring washer						2	3075	
Nut (5/16" UNF)						2	254831	
Bleed screw						1	556508	
Shakeproof washer						1	70822	
Locknut						1	254862	

] Fixing bleed screw  
to bracket

\*Asterisk indicates a new part which has not been used on any previous model.